

CRYSTORAMA

LIGHTING THE WAY FOR SIXTY YEARS

ASSEMBLY INSTRUCTION MODEL #8863-PN

For Hanging:

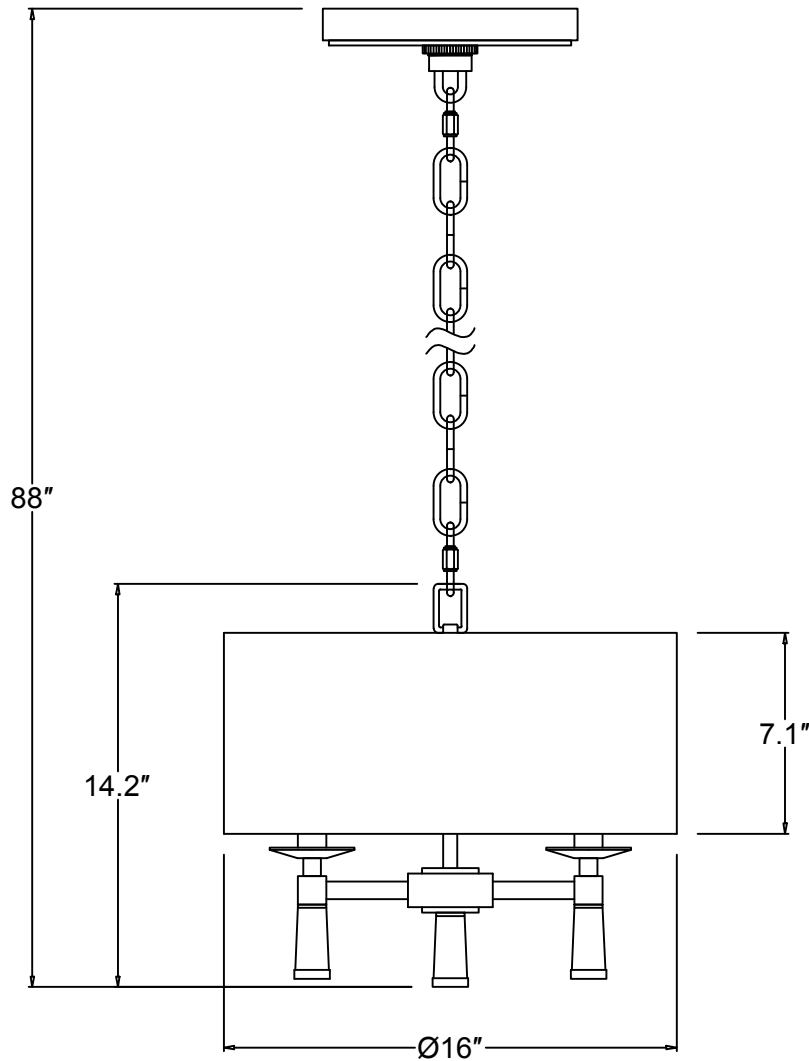

For Ceiling:

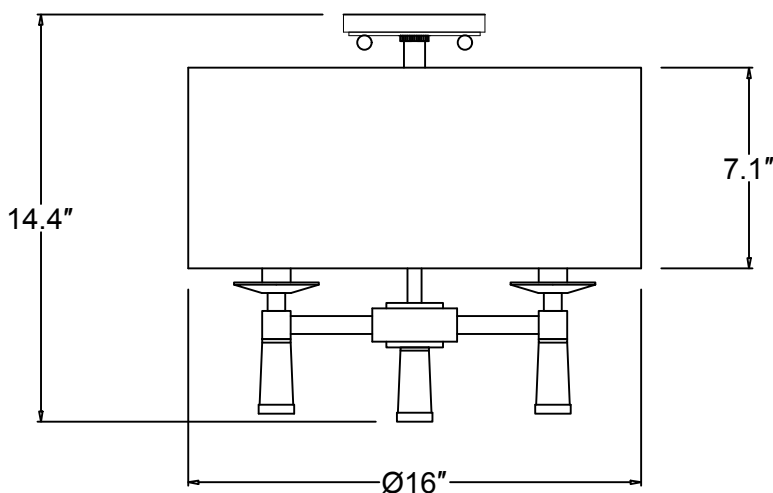

WARNING



Electrical Danger



Turn Power Off

All electrical components must be installed by a licensed electrician in accordance with the National Electric Code and the appropriate local electrical codes.

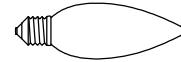

You will need 3-Candelabra Bulb
40 Watts Recommended 60 Watts Max
Bulb not included
USE LED BULBS FOR EXTENDED USE
This fixture is DRY rated

How to Install

For hanging

1. Insert the shade onto the center rod and secure with the knurled nut.
2. Decide the preferred hanging height and choose the chain needed.
3. Fix the mounting plate to the ceiling and attach the canopy to the mounting plate.

For ceiling

1. Insert the shade onto the center rod and secure with the knurled nut.
2. Take the fixture loop off and put the canopy (with two mounting holes) over the top of shade. Secure with the hex nut.
3. Install the frame onto the ceiling.
4. Screw the lucite finial onto the frame.

 **WARNING:** This product can expose you to Lead, which is known to the State of California to cause cancer and/or birth defects or reproductive harm. For more information go to www.P65Warnings.ca.gov

CRYSTORAMA

LIGHTING THE WAY FOR SIXTY YEARS

PART NUMBER MODEL #8863-PN

Part Number

Part Numbers

- A. Mounting Hardware
(1) Mounting Plate
(2) Wire Nut
(2) Outlet Box Screws
B. (1) Screw Collar Loop
C. (1) Canopy; Ø5"x0.8"h; XMO8863PNCAN5IN
D. Mounting Hardware
(1) Mounting Plate
(2) Wire Nut
(2) Outlet Box Screws
E. (1) Canopy for ceiling; Ø5"x0.8"h; XMO8863PNCAN5IN
F. (2) Ball nut; XMO8863PNBANUT
G. (1) Collar Ring
H. (2) Quick Link
I. (1) Chain; 72"LxØ5.0mmT; XMO8863PNCHA5MM
J. (1) Loop; XMO8863PNLOOP
K. (2) Knurled nut
L. (1) Shade; Ø16"x7.1"h; XMO8863PNSHA7.1IN
M. (1) Center rod; Ø0.5"x7.4"h; XMO8863PNROD7.4IN
N. (3) Socket
O. (4) Lucite finial; XMO8863PNLUCFIN

